

# Campanello

## Basic instructions



1. The ribbon consists of three parts, knit one part, the two other parts form the frill. You can choose whichever colour you want for knitting.



2. With this special yarn there are three different ways to knit the scarf. Knit stitches, to be taken from the upper ribbon edge, at intervals of approximately 4-5cm. The use of jacket needles is recommended.

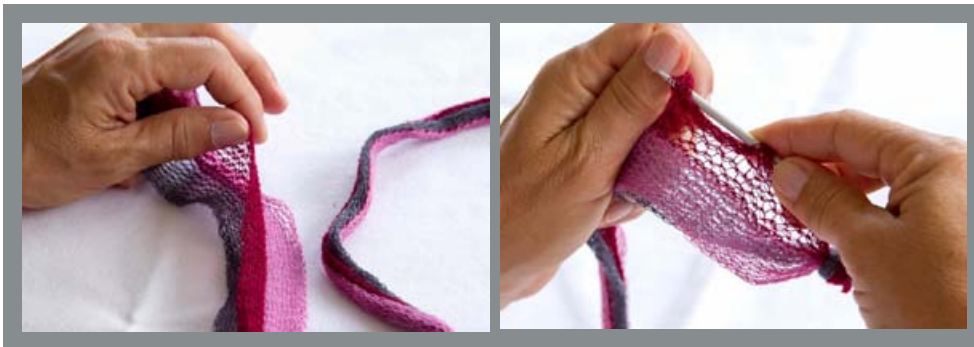

3. The stitches are not cast on as usual. Pick up the stitches from the upper ribbon edge by stitching from back to front below the upper ribbon edge, at intervals of approximately 4-5cm. Since the ribbon is very delicate it is recommended to stitch approximately 1 cm below the edge so that the stitches are a bit firmer (thicker).

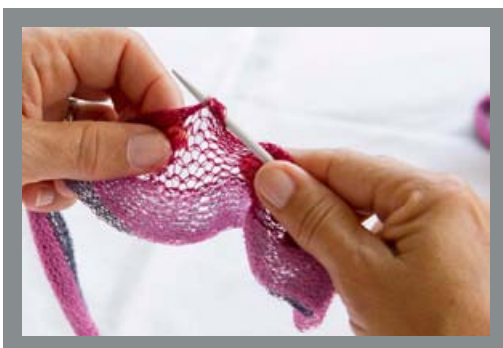

# Campanello

## Basic instructions



4. Knit the first and all following rows as follows: The ribbon runs at the backside of the piece of knitting. With the right needle, stitch into the first stitch on the left needle as if to knit, ...



5. ... take up one stitch from the upper ribbon edge (stitching from back to front). Pull this stitch through the stitch on the left needle, and let that stitch slip off the needle. Repeat until all stitches are done.

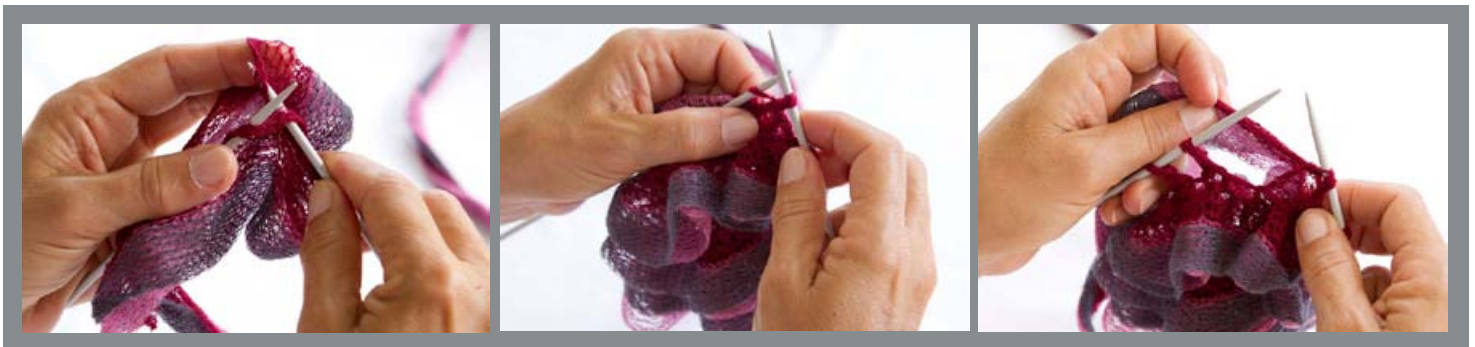

6. Bind off the stitches as usual, but use only the upper ribbon edge as well.

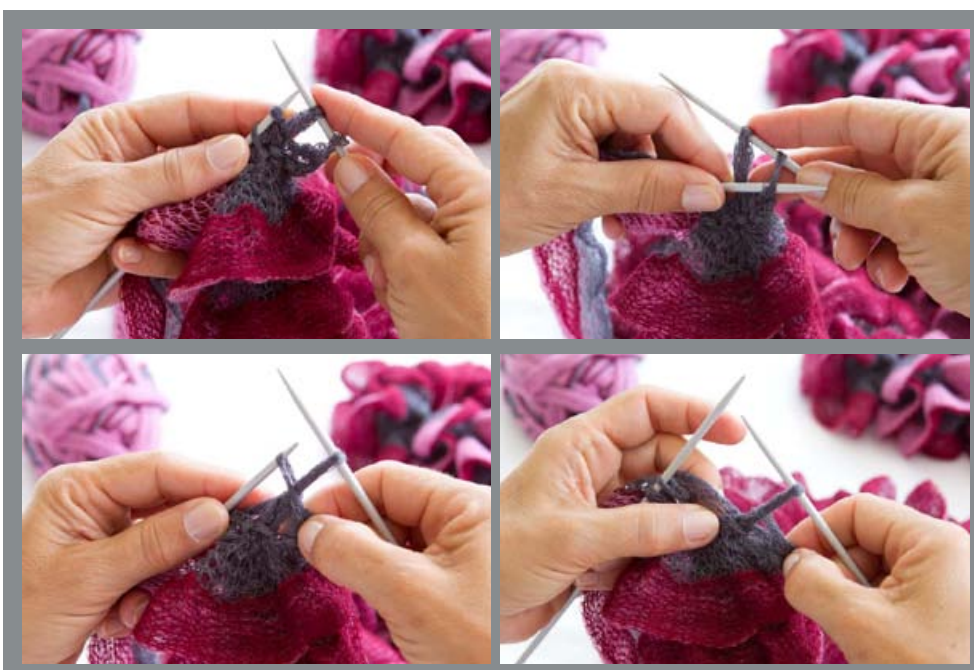

Secure the starting and the end thread with a knot, or stitch them down slightly. If another ball of wool is required, join the two threads and secure them using a sewing thread.